

Keurig K-Cup Brewer For CFE28 and CYE22 Models

Quick Start Guide

257C2150P001 31-49087-1 02-16 GE

1

Load Keurig K-Cup into brewer.

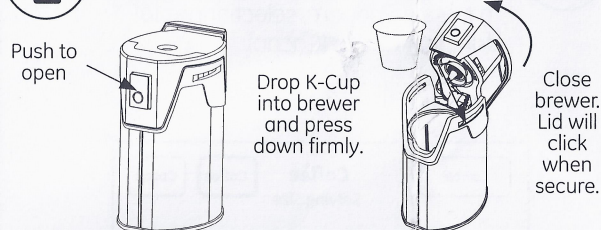

⚠ CAUTION Cut/Puncture Hazard

- There are two sharp needles located inside the K-Cup brewer. To avoid risk of injury, do not put your fingers inside the brewer. Use caution when cleaning.
- Keep the K-Cup brewer out of the reach of children, as they may be injured in using the K-Cup brewer incorrectly.

2

Two Ways To Brew:

1. Press Hot Water. Select K-Cup Pod.
- OR
2. Slide the brewer into the rails.

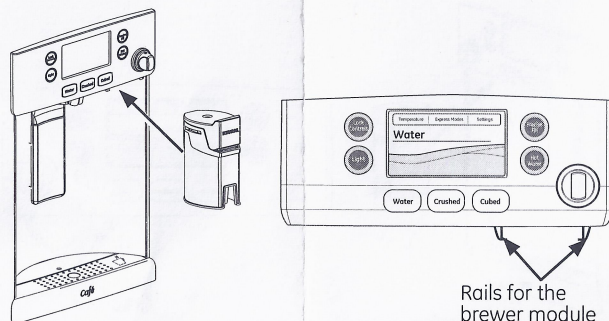

3

Pick your size.

NOTICE: If using a powdered beverage, select the Cocoa setting.

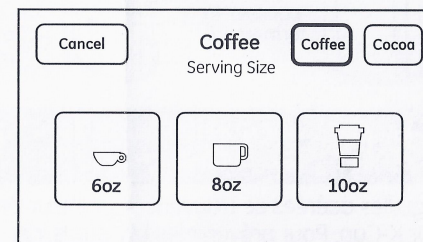

4

Place your mug under the brewer (on the tray mug icon and under the red brew spout).

NOTICE: Make sure the mug being used is large enough for the size selected.

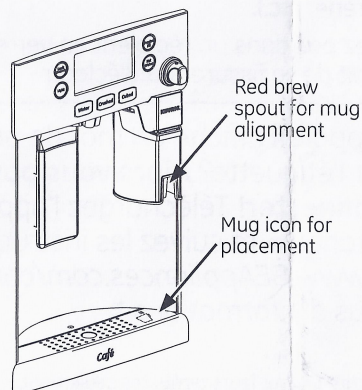

5

Rotate the hot water knob counterclockwise and push in, to brew and dispense.

NOTICE: Press any button or dispenser paddle, or open either the left or right door to cancel dispense.

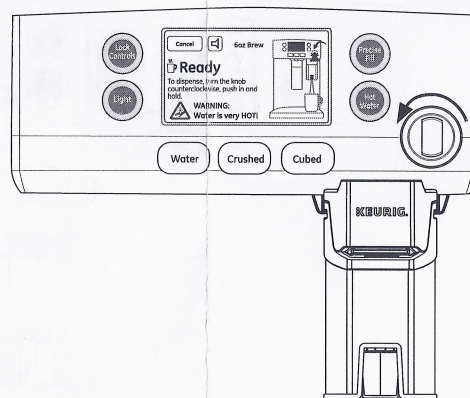

⚠ WARNING Scalding Hazard

- The water coming from the dispenser is very hot and can cause scalds or burns. **Read all warnings in the Owner's Manual that was included with your refrigerator prior to use.**
- Do not permit children to use the brewer.
- Always use a container that is suitable for hot liquids (ceramic, foam, etc.)
- Do not brew into a mug made of glass. Doing so may cause the glass to crack or break.

Does your unit have a WiFi password on the label? **You can connect!** Download the App "GE Kitchen" and follow the instructions.

Visit www.GEAppliances.com/connect for more information.*

* For US and US Territories only.